

QUICK SETUP GUIDE

AVR-50-STC20
50" FHD DLED TV

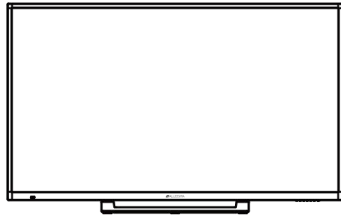

PACKAGE CONTENT:



50 FHD DLED TV



Remote Control



USER MANUAL

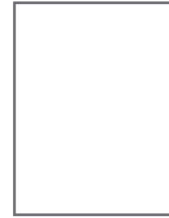

QSG

CONNECTION OPTION

Back Connection Panel

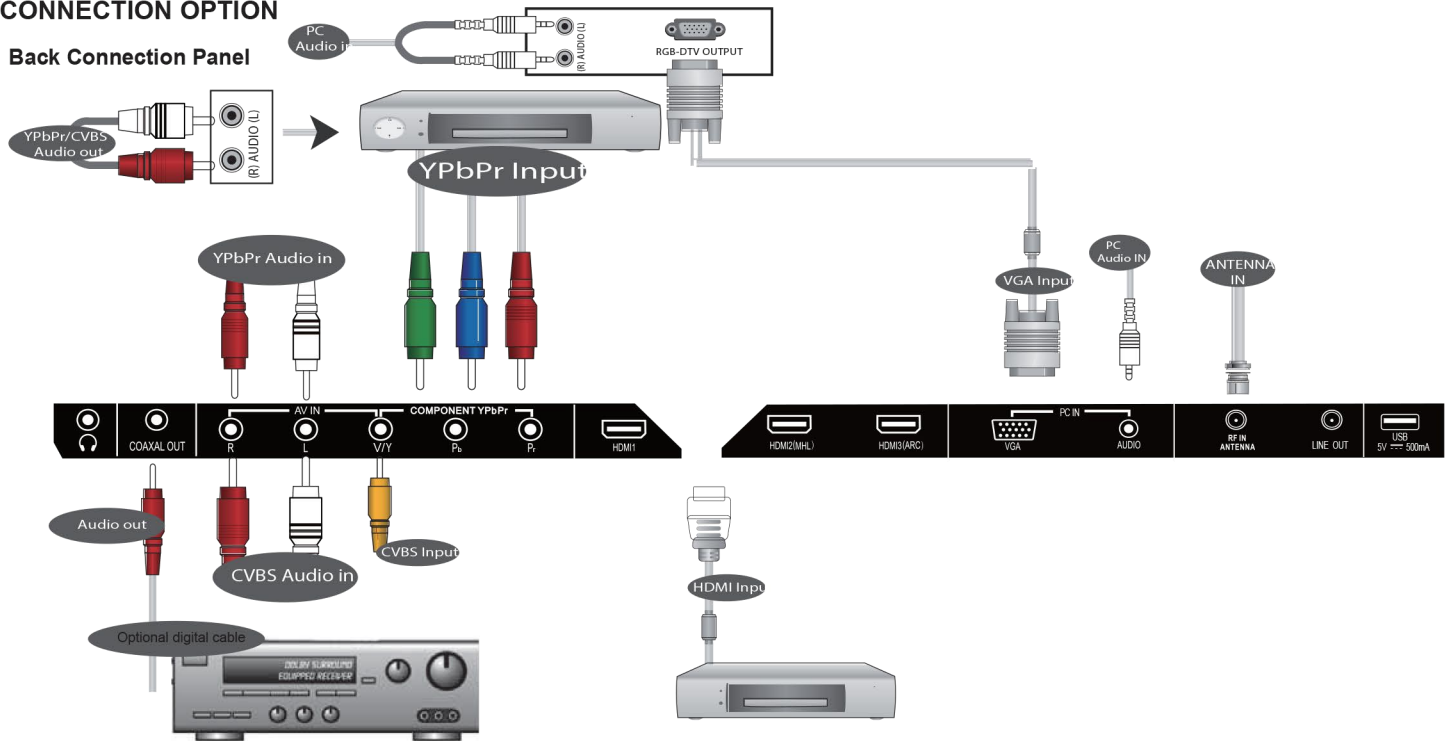

Your remote control handset is powered by two (2) AAA type batteries



control over and remove the battery cover.

compartment with correct polarity.

IMPORTANT SET-UP INFORMATION

- NOTE: Connect an antenna cable (CATV) to the corresponding interface connector (75 Ω ANT) on the back of the LED-TV. Connect the other end of the antenna cable to the antenna connector on the wall or on your digital cable / satellite receiver. Now you are able to view regular cable TV.
- Turn on the power of the LED-TV.
- Initial Setup Menu
NOTE: If this is the first time you turn on the LED TV, the Initial Setup Menu will display.
- Menu Language
Select the preferred language when viewing on screen menus. Use the OK button to select language.
- Tuning Band
Select Tuning Band mode. Press OK button to select Air/Cable STD/Cable HRC/Cable IRC/Cable Auto.
- Auto Channel Search
When using your LED TV for the first time. Please scan for all available broadcasting channels in your local area. Press OK button to enter the Auto Channel Search Program.
- NOTE: Auto Channel Search for TV channels in your local area may take several minutes to complete.